

ALPS EVOLVE SERIES

RECESSED COMMERCIAL LUMINAIRE

Flat panel

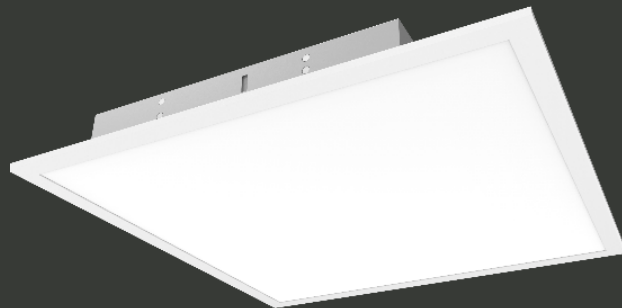

The ALPS series is a backlit panel product designed with optimum LED placement to ensure a uniformly lit diffuser. It features a switchable CCT, and power package enable an endless flexibility at the install site. The average 130 LPW performance also makes the ALPs an ideal replacement for any existing recessed commercial ceiling products.

Project: _____

Qty: _____

Notes: _____

OPERATING & ELECTRICAL

Input Voltage 120-347Vac
Power factor 0.9
Total harmonic distortion (THD) <20%
Dimming 1-10V external dimming down to 10%

PERFORMANCE

Lumens per Watt 125 LPW at 80CRI
Power consumption 20 to 50 W
CCT Switchable 30/35/40/50
Beam angle Lambertian

MECHANICAL & HOUSING

Housing Aluminum frame
Lens Enhanced quality diffuser
 ensures high efficiency light output for a clean, evenly illuminated surface

Finish

White

Power Supply driver

Factory wired electronic LED

LED Board

LED Array

APPLICATION CONDITION

Ambient temperature range
Protection

-20 to 45°C
 Dry rated

COMPATIBLE MOUNTING

Mounting DX, DXT Grid, surface mount

WARRANTY

System warranty 5 years
Lumen maintenance Rated for 85% initial lumen output at 50,000 hours of operation, operated at 25°C ambient temperature; per guidelines published by the Illuminating Engineering Society (IES). (L85 at 50,000 hours)

ORDERING GUIDE

EXAMPLE: AE-RC-APB-XXW24-28CDMH-01

AE-RC-APB	-XXW	24	-28CDM	H-01
FIXTURE FAMILY	POWER	SIZE	CONTROLS	INPUT VOLTAGE
AE-RC-APB ALPS Evolve series commercial office backlit panel	-XXW 2x4: 35-40-45-50W 2x2: 20-25-30-35W 1x4: 20-25-30-35W CCT Selectable: 3000/3500/4000/5000K	22 2'x2' housing	-28CDM 0-10V external dimming down to 10%	L-01 120-277Vac
		24 2'x4' housing		
		14 1'x4' housing	-28CSM Microwave Motion Sensor	H-01 120-347Vac



PRODUCT DIMENSIONS

2x2

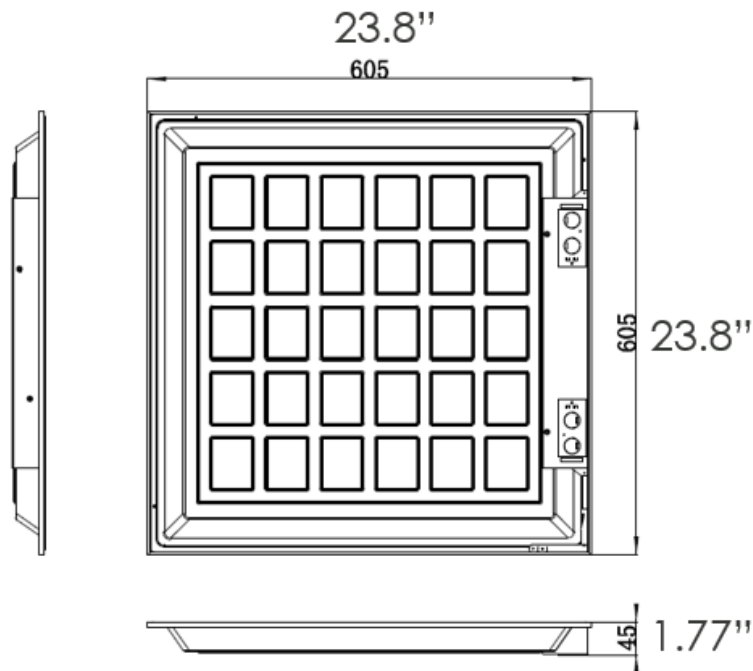

1x4

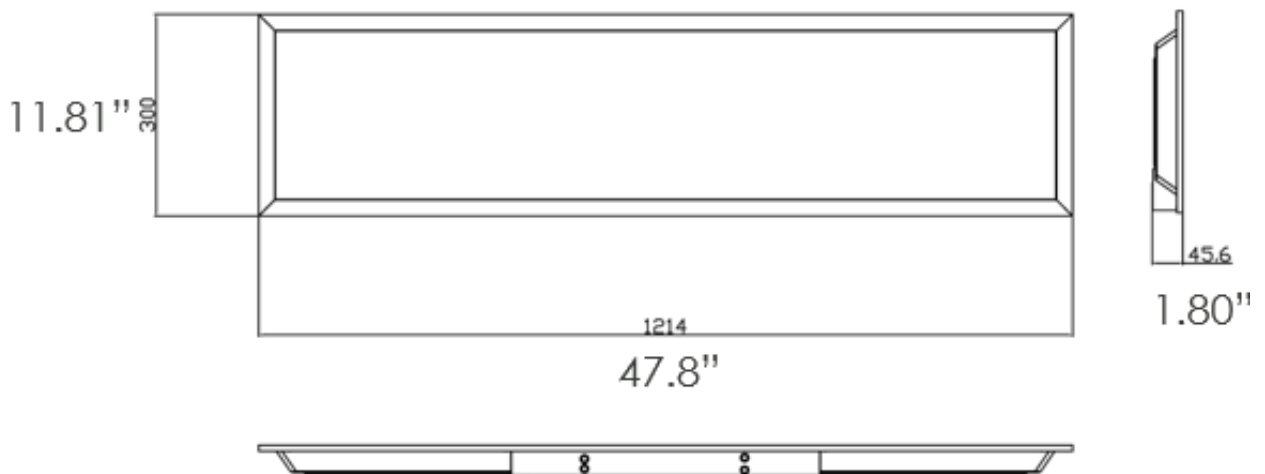

PRODUCT DIMENSIONS

2x4

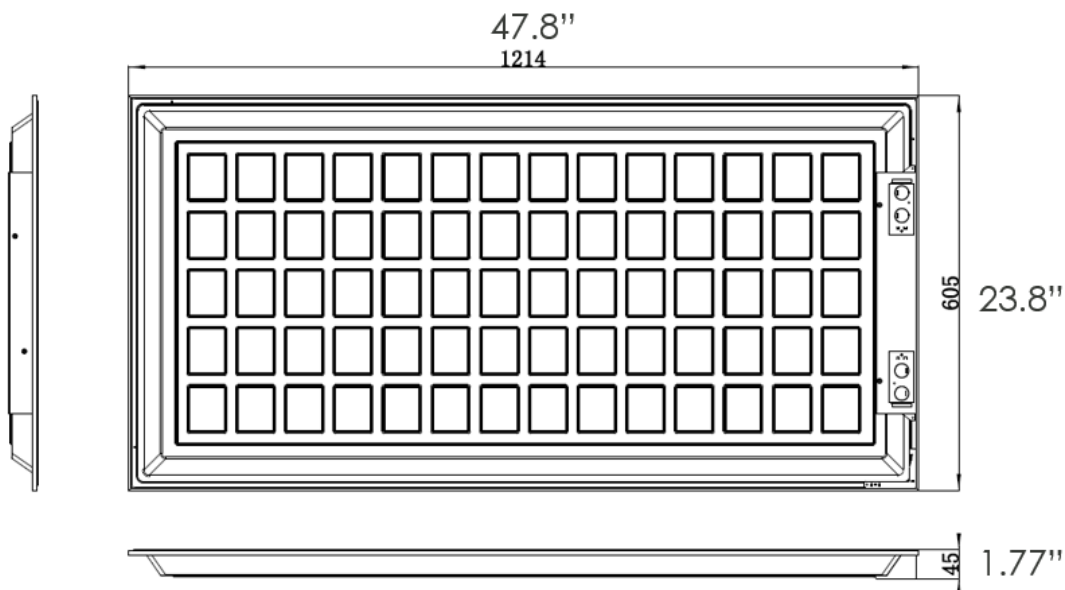

LUMEN ESTIMATE

Lumen output varies based on CCT and CRI. An estimate of lumen output of the various CCT/CRI combinations, use correction factors as per table below:

Lumen estimate adjustment factors

CCT	2700K	3000K	3500K	4000K
NORMAL (80CRI)	0.91	0.94	0.97	1

PHOTOMETRIC DATA

AE-RC-APB-XXW22-28CDML-01-35

LUMINOUS INTENSITY DISTRIBUTION DIAGRAM

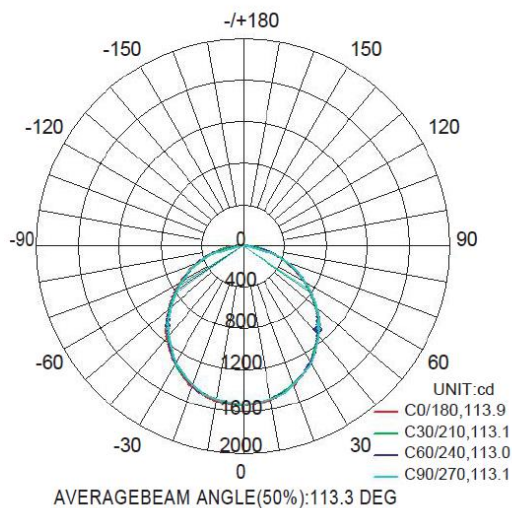

C0 PLANE ISOLUX DIAGRAM (UNIT: lx)

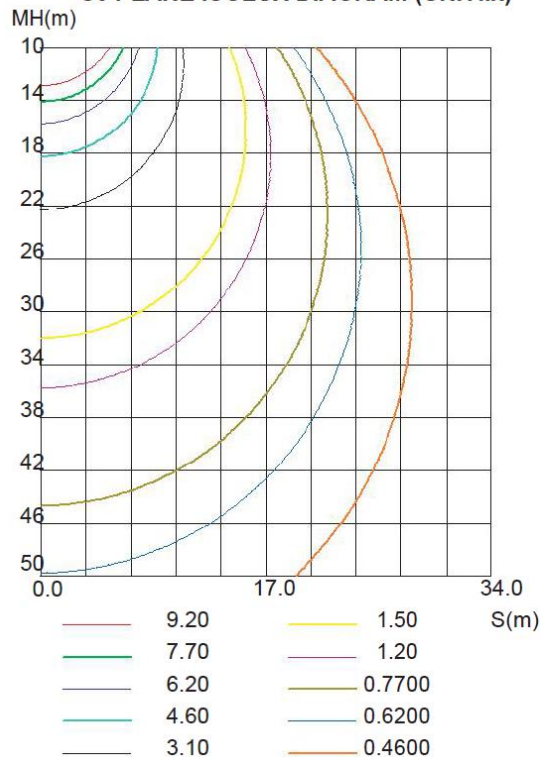



ALPS EVOLVE

RECESSED COMMERCIAL LUMINAIRES

Flat panel

OVERVIEW

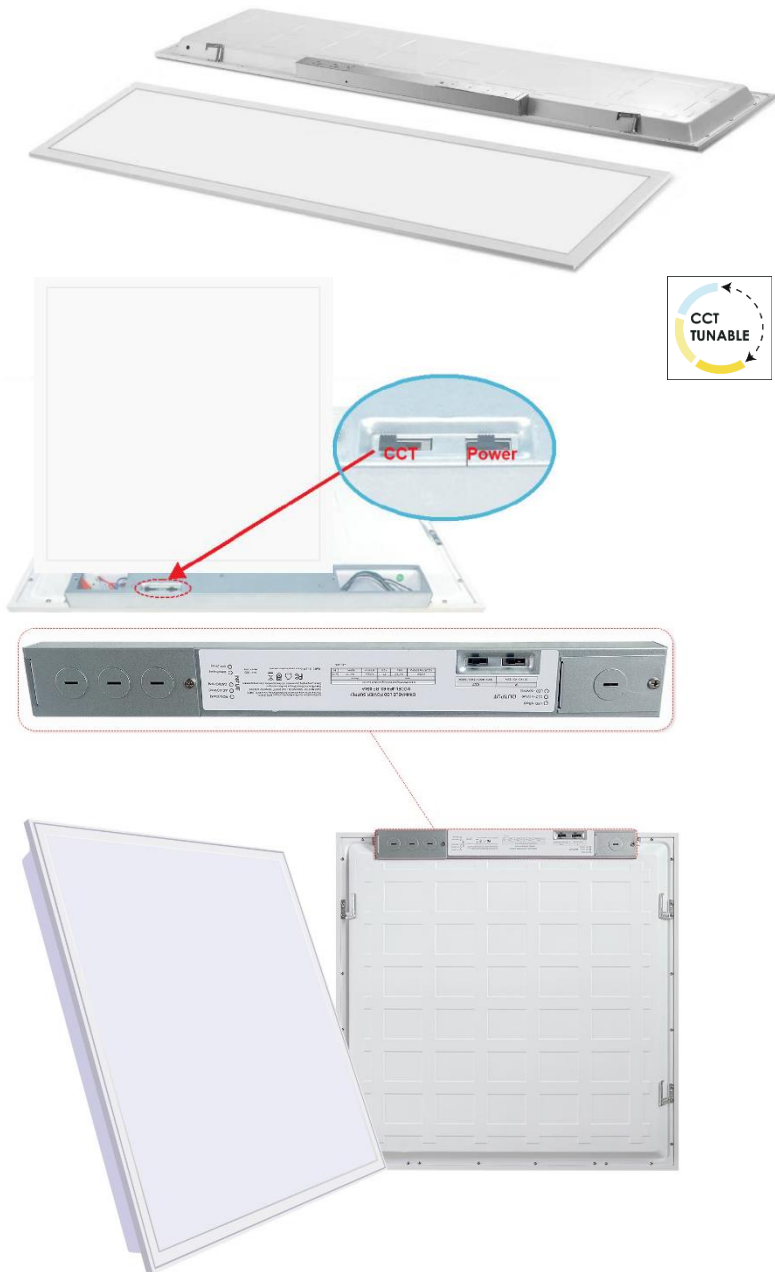

VOLTAGE RATING

Multiple input voltage ratings, 120-277Vac or 120-347Vac, perfect for both American and Canadian Markets.

MULTIPLE PACKAGES

Select from the standard 0-10V dimming model or add the additional 90-minute emergency battery back-up kit.



THIN PROFILE

Ultra-thin housing with polystyrene reflector enable the 2nd generation Alps fixture to be extremely lightweight while providing an elegant appearance.



ERALUX Inc.
1-514-447-7598 | 1-630-534-2589
www.ERALUX.com

ERALUX Incorporation All Rights Reserved. Any information provided is subject to change without notice. All values are typical values when measured under normal laboratory conditions.

eralux