

SPECIFICATION SHEET

SUBJECT

LED PHBF

CUSTOMER PROJECT

Project: _____
 Type: _____
 Cat. No.: _____
 Qty: _____
 Date: _____
 EEL Rep: _____



HIGH PERFORMANCE LED HIGH BAY PHBF

PERFORMANCE HIGH BAY

PHBF SERIES

Wattage(s)	105W, 165W, 225W, 300W
Voltage	120-347V
Dimmable	0-10V
CCT	4000K, 5000K
Efficacy	Up to 140lm/W
Lumen Maintenance	Theoretical L70 > 191,000h Lumen maintenance at 36,000 hrs = 93.85%
CRI	≥80
Operating Temperature	-30°C to 45°C
Inherent Surge Protection	4kV+10kV extra surge
PF	0.9
THD	15%

Note: Not recommended to be used in application with chemical processing; for applications with chemical processing, fixtures rated for IP65 and higher are recommended.



www.eelighting.ca



Telephone: 905 415 8878 Fax Number: 905 415 8872 Toll Free Telephone: 855 415 8878 Toll Free Fax: 855 415 8872

DESCRIPTION

The PHBF series in our Linear High Bay category follows the success of our PHB-III series. This generation boasts an efficacy of 140lm/W and features a streamlined design with superior heat dissipation. Extra consideration has been taken during our design and tooling process to allow us to further reduce potential insect-access points in a sealed design.

The PHBF series comes with inherent 4kV surge protection. An additional 10kV is also provided. The included 10ft 600V cord, V-hooks, and 3ft chains make for ease of installation. A full gambit of optional accessories (wire guards, pendant hangers, emergency backup, and controls) round out the well-equipped PHBF series.

SPECIFICATION FEATURES

Construction

- Steel housing coated with high reflective paint
- 10 ft cord, "V" hooks and chains are included
- Length of chain: 1000mm / 39.37"

Mounting

- Suspension
- Pendant
- Surface

Beam Angle

- 120° standard

Shielding

- Polystyrene (PS) Lens

Compliance

- DLC
- Suitable for Damp Locations
- cUL
- The basic standard used to investigate products that are UL 1598 ("Luminaires") certified, also conforms to CSA-C22.2 No. 250.0 ("Luminaires").

Warranty

- 5-Year Warranty (Standard)
- 10-Year Limited Warranty (Optional)

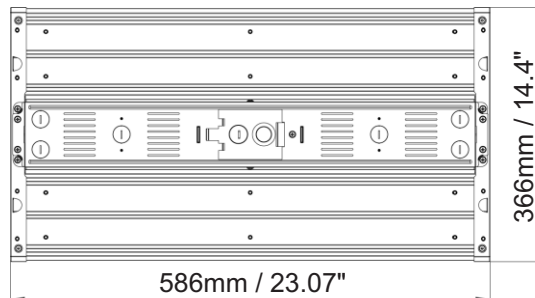

PHBF - 105W & 165W
 Dimensions
 mm | 586(L) x 366(W) x 48(D)
 inch | 23.1(L) x 14.4(W) x 1.9(D)

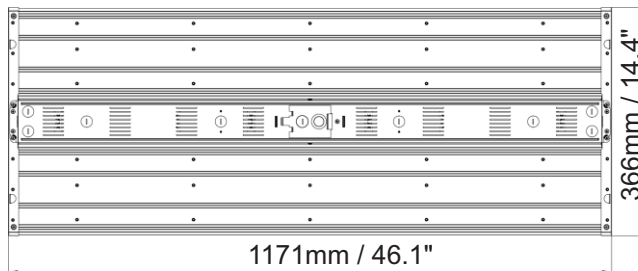
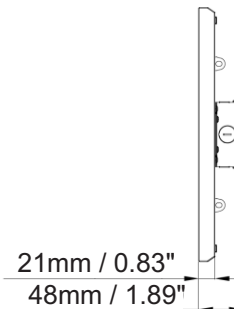



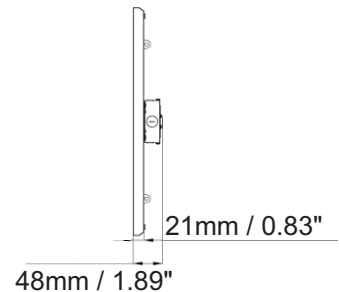









PHBF - 225W & 300W
 Dimensions
 mm | 1171(L) x 366(W) x 48(D)
 inch | 46.1(L) x 14.4(W) x 1.9(D)



...continued

Telephone: 905 415 8878 Fax Number: 905 415 8872 Toll Free Telephone: 855 415 8878 Toll Free Fax: 855 415 8872

ORDERING CODE, ENERGY AND PERFORMANCE DATA

Model No.	Delivered Lumens (lm)	Input Watts (W)	Voltage (V)	Colour Temp. (K)	Efficacy (lm/W)	Certification
 PHBF-2-7224 105W40K-120347V-D110V-E130	15522	108	120-347	4000K	140	
 PHBF-2-7225 105W50K-120347V-D110V-E130	15605	108	120-347	5000K	140	
 PHBF-2-7244 165W40K-120347V-D110V-E130	22715	163	120-347	4000K	140	
 PHBF-2-7245 165W50K-120347V-D110V-E130	22715	163	120-347	5000K	140	
 PHBF-4-7264 225W40K-120347V-D110V-E130	30309	217	120-347	4000K	140	
 PHBF-4-7265 225W50K-120347V-D110V-E130	30309	217	120-347	5000K	140	
 PHBF-4-7274 300W40K-120347V-D110V-E130	41143	295	120-347	4000K	140	
 PHBF-4-7275 300W50K-120347V-D110V-E130	41871	295	120-347	5000K	140	

NOTE:

- Lumens are estimated.
- Lumens may vary based on lens option.
- DLC qualified may not apply to all versions within a model. Please check the DLC Qualified Products List at www.designlights.org to confirm which versions are qualified.

CONTROLS (OPTIONAL)

SMF2025 | 06VCRH Microwave Motion Sensor (0-10V Dimmable, DC 10-15V)

RC1030 | Remote control for SMF2025 (this product cannot be sold separately and must be purchased alongside the Microwave sensor SMF2025)

EMERGENCY BACK-UP (OPTIONAL)

EMP-P4035 | Emergency Battery Pack 25W output, 170V (100-347V)

OPTIONAL ACCESSORIES

PHBF-2-A2131-WG | Wire Guard for 2ft PHBF series

PHBF-4-A2131-WG | Wire Guard for 4ft PHBF series

PHBF-U-A2131-PH | Pendant Hanger for PHBF series



SMF2025



RC1030

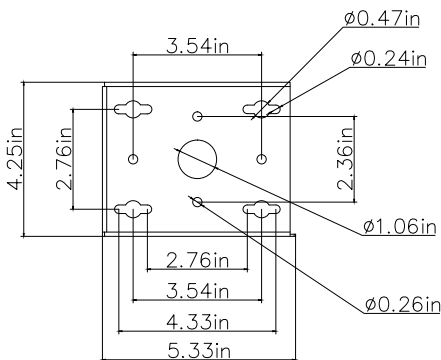
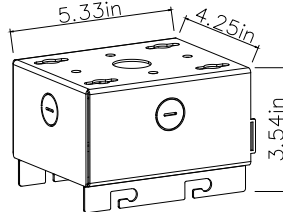
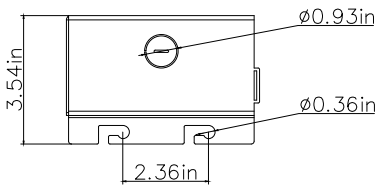

PHBF Pendant Hanger



Please allow for tolerance on specifications and dimensions.
If required, please consult EEL.

www.eelighting.ca

R220324-1530

...continued

Telephone: 905 415 8878 Fax Number: 905 415 8872 Toll Free Telephone: 855 415 8878 Toll Free Fax: 855 415 8872

2' Wire Guard

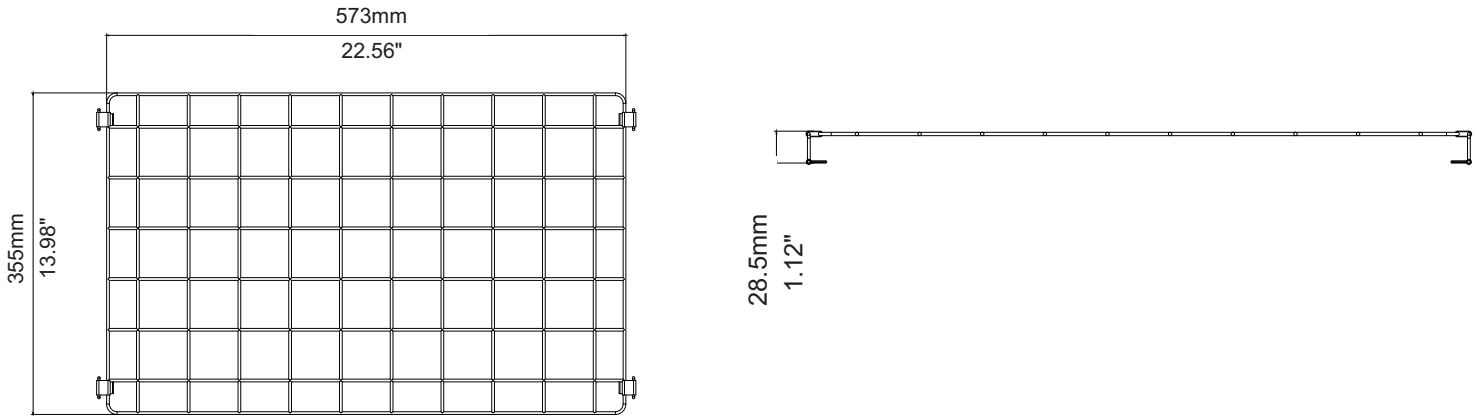

4' Wire Guard

