

⚠ WARNING

1. Only qualified electricians should install this luminaire. All electrical and grounded connections MUST be in accordance with the National Electrical Code, the Canadian Electrical Code, and any other applicable local code requirements.
2. In case of smoke, or sparks emerging from the wire, please switch off the power supply to the wire immediately and notify the relevant personnel.
3. Minimum 90°C Supply Conductor Requirement.
4. Do not expose this fixture to direct water. This fixture is not waterproof, and is ONLY suitable for damp locations.
5. Please do not stare directly at the LED Lights, and wear gloves before installing the fixture to avoid an injury.
6. Please inspect the fixture for any damages (arising from shipment) before installing, and contact ARANI immediately.
7. Please read the installation instructions and confirm that the included accessories are in the box prior to installing the fixture.
8. This fixture is designed to operate in ambient temperatures ranging from -20° to 40°C. Using it in temperatures outside this range will reduce its lifespan.
9. Switch OFF the main power supply (at the fuse/ circuit breaker) before wiring-in the fixture and ensure it remains switched off during the length of the installation.
10. Please clean the luminaire regularly to maintain the fixture and ensure its longevity.
11. The edges of this fixture may be sharp. Handle with care to avoid an injury.

| Model Number | Input voltage | Color temperature | Power Selectable | Rated Current |
|-------------------------|---------------|---------------------------------|------------------|---------------|
| WRP48L0046W-DHV13P3C-V2 | 120-347Vac | Selectable 3500K/4000K/5000K | 46W/38W/30W | 0.5A |

Product Dimensions

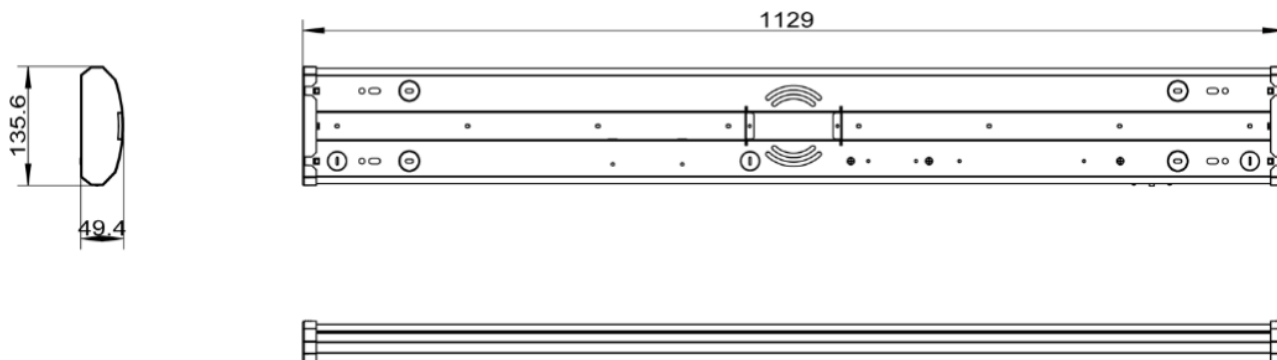

Installation Instructions

1. **Removing the Lens and Plug:** Carefully remove the plug and the lens from the luminaire by pulling it up from the edge - near the endcap (see Fig. 1).
2. **Compatibility and Wiring:** The LED wrap fixture is compatible with a 4" surface J Box with a 3.5" mounting hole space, or a 3" J Box with a 2.75" mounting hole space. Locate the wires in the outlet box and connect the fixture's wires to the power supply wires using wire nuts (see Fig. 2) For wire connections please follow: white to white, black to black, and green to green. For dimming installation, refer to the wiring diagram.
3. **Connecting Wires:** After connecting the wires, push all the wires and wire nuts inside the junction box (see Fig. 3).
4. **Mounting:** Align the fixture mounting slots with the J Box mounting holes and use 8-32 x 25 mm mounting screws to secure the fixture to the J Box (see Fig. 4).
5. **Securing the Fixture:** Ensure there are no visible gaps between the ceiling surface (at the outlet box) and the luminaire housing. For added stability, use 2-4 screws to strengthen the fixture (see Fig. 5).
6. **Attaching Lens:** Attach the lens (see Fig. 6) by aligning the lens groove with the edge of the channel. Ensure the lens groove is secure along the length of the lens on both sides. Remove the protective film from the lens.
7. **Powering On:** Turn on the main power supply to the fixture, and use the wall switch to ensure the light turns on.

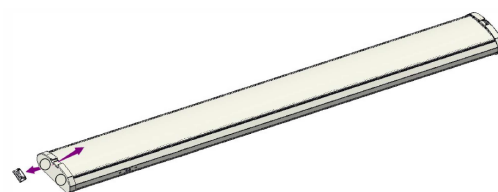

Fig. 1



Fig. 2

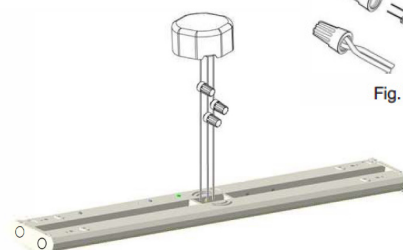

Fig. 3

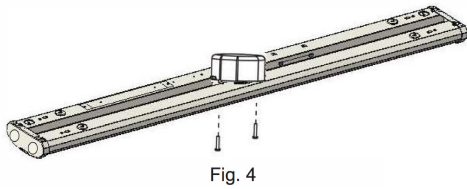

Fig. 4

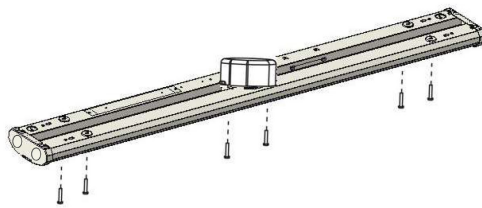

Fig. 5

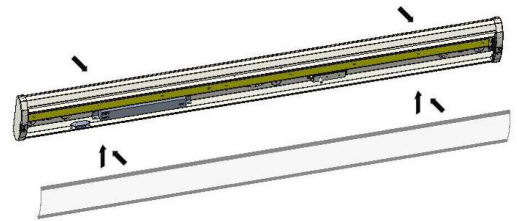

Fig. 6

INTER-CONNECTING MOUNT

A connection can be made between 2 luminaires using an armoured cable, or 1/2" tubing with 1/2" connectors (not included). (Fig. 7 and Fig. 8)

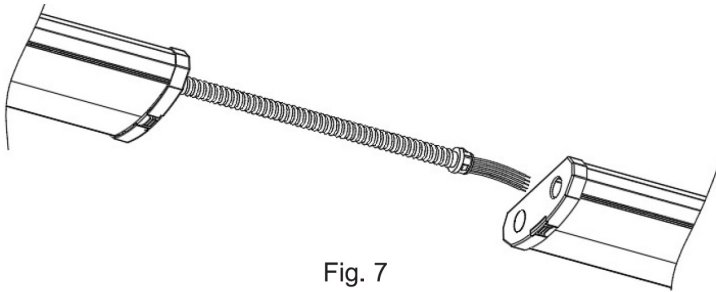

Fig. 7

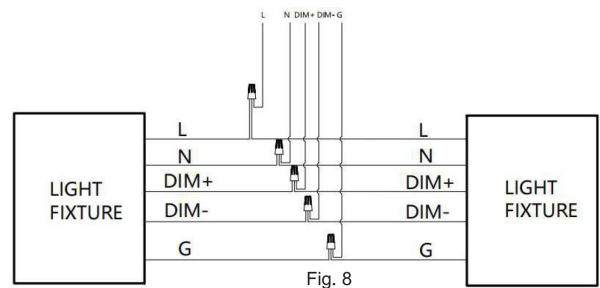
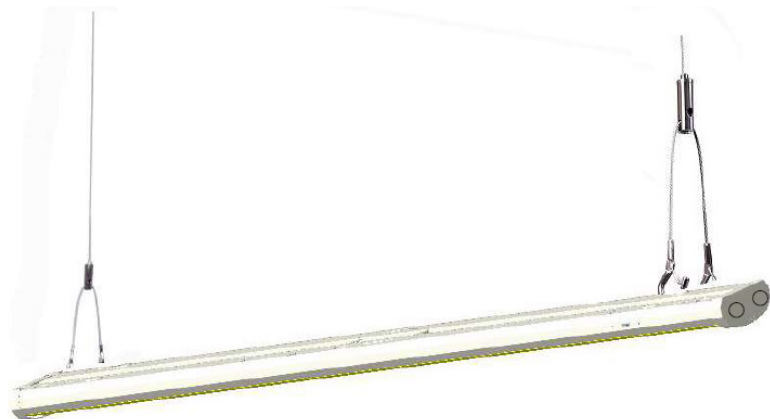

Fig. 8

PENDANT MOUNT (Aircraft cable)

The luminaire can be suspended with a suspension kit (sold separately).

fig 9



WIRING DIAGRAM

CAUTION: Turn off the electrical power at the fuse or circuit breaker box before wiring the fixture to the power supply. The universal voltage driver permits operation at 120-347Vac 60Hz. The 0-10V control wires must ATLEAST be rated for 300V (minimum). For 0-10V dimming, follow the wiring directions as shown in Fig. 10.

- Connect the black fixture lead to the LINE supply lead.
- Connect the white fixture lead to the NEUTRAL supply lead.
- Connect the green fixture lead to the supply ground.
- Connect the violet fixture lead to the DIM(+) lead.
- Connect the pink fixture lead to the DIM(-) lead.

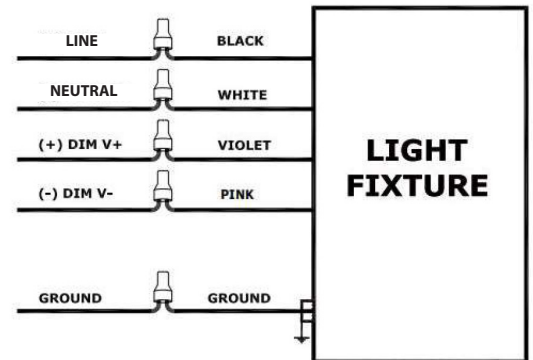

Fig. 10